



A Contemporary Designed Two Bedroom End Terrace/Terraced Home

The entrance hallway of The Winthorpe leads onto the staircase to the first floor and into a good sized living area which also includes convenient storage for those essential items. From the living area there is access to a downstairs WC and a stylish kitchen/dining area with French doors to the rear which extend your living space onto a patio area and a well-proportioned rear garden. Additionally the property benefits from a dedicated front driveway.

Upstairs, you'll find a spacious master bedroom with space for fitted wardrobes and additional storage areas. A further generous sized double bedroom is also located to the rear. A family bathroom with full-height tiling, heated towel rail, contemporary sanitary ware is conveniently located to serve both bedrooms. Gas central heating throughout is controlled by a modern "Hive" compatible smart thermostat.

Key Points

- French doors to the rear garden space and patio area
- Choice of a wide range of stylish kitchens with integrated appliances
- Dedicated driveway to the front of the property with additional parking nearby.
- Master bedroom with space for fitted wardrobes
- Additional generous sized double bedroom/home office
- Gas central heating with Hive compatible smart thermostat
- Chrome electrical fittings throughout
- Fitted flooring throughout

Type H Dimensions

All maximum unless stated otherwise. All taken to face of plaster as shown on drawings.

GROUND FLOOR

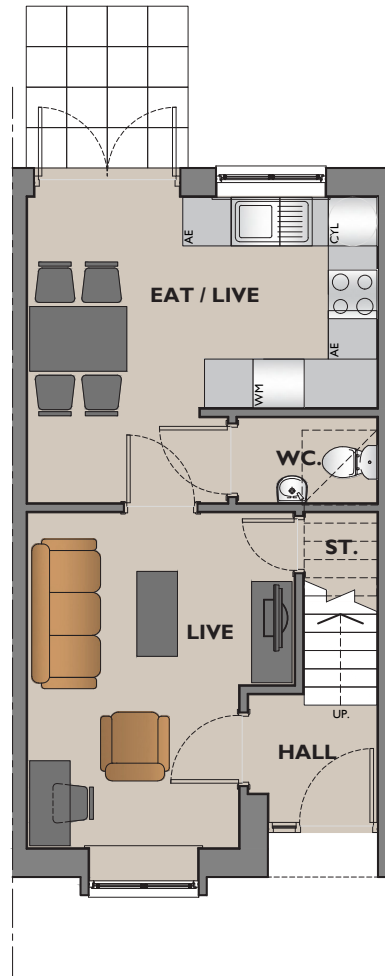

The Winthorpe

GROUND FLOOR

Ground Floor

Live – 3290mm x 4140mm.

Eat / Live – 3775mm x 4300mm.

WC – 1060mm x 1725mm.

FIRST FLOOR

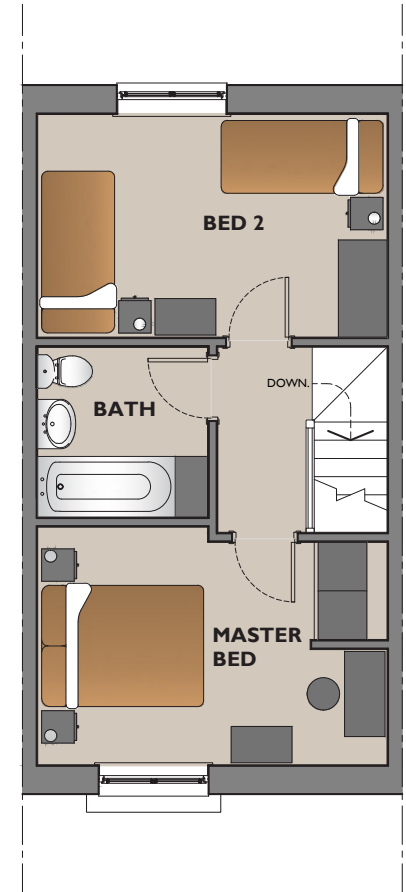

The Winthorpe

FIRST FLOOR

First Floor

Master Bed – 2935mm x 4300mm.

Bed 2 – 2750mm x 4300mm.

Bath – 2100mm x 2100mm.

Gross internal floor area – 68.5m².

All images, photographs and dimensions are for illustrative purposes only and are not intended to be relied upon for, nor to form part of, any contract unless specifically incorporated in writing into the contract. The dimensions given are illustrative for this house type, individual properties may differ and dimensions should not be used for carpet or flooring sizes, appliance spaces or items of furniture.